

# DC22 - Turn Counting Dial and Potentiometer

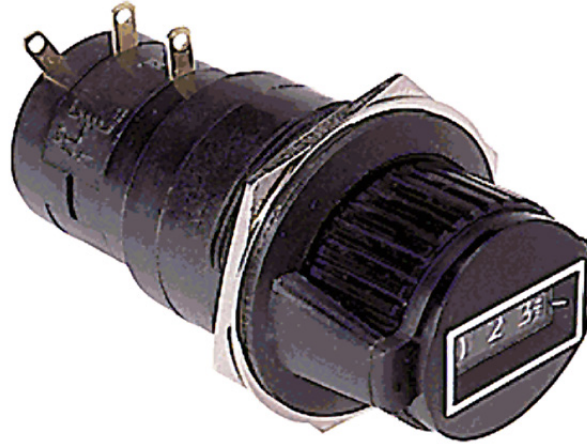

For more information about this product, visit our website at:  
[www.potentiometers.com](http://www.potentiometers.com)

## *Series DC22 Precision Digital Turn-Counting Dial and Potentiometer Combination*

### Features

- Counts up to 10 turns (000-999)
- Resistance range: 100 to 100K ohms
- Resistance tolerance:  $\pm 5\%$  standard
- Linearity tolerance:  $\pm 0.25\%$  standard
- Temperature Coefficient:  $\pm 20$  ppm/ $^{\circ}\text{C}$
- Power Rating: 2 watts
- Accuracy:  $\pm 0.35\%$  of Voltage Ratio
- Repeatability:  $\pm 0.02\%$  or Resolution of Pot
- High Temp. Black Plastic Housing
- Over the Center Lock (standard)
- Wirewound Potentiometer: [Model MW22](#)
- Numbers increase with clockwise rotation

### Mechanical Specifications

Turns Counted: 10  
Total Count: 0 to 999  
Diameter: 1.20"  
Extension from Panel: .70"  
Operating Temperature:  $-30^{\circ}\text{C}$  to  $+85^{\circ}\text{C}$

# DC22 - Turn Counting Dial and Potentiometer

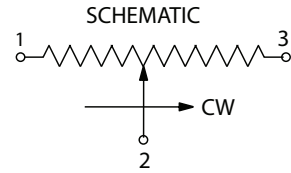
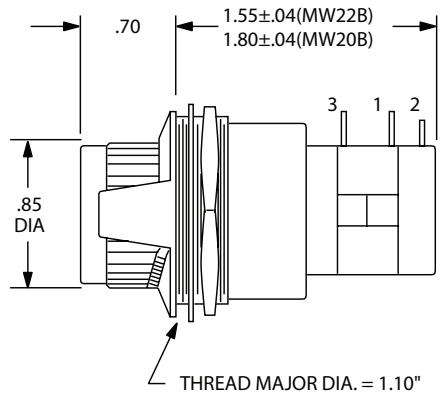
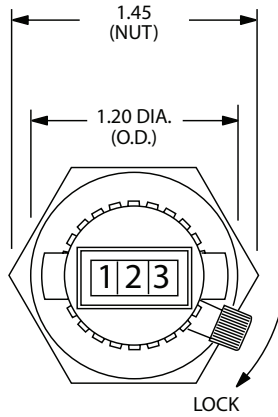

THREAD MAJOR DIA. = 1.10"  
 REQUIRED MOUNTING HOLE IN PANEL = 1 1/8"

## Ordering Information

Example Part Number: **DC22-102**

DC22	102
Model	Resistance
	101 - 100 ohms
	201 - 200 ohms
	501 - 500 ohms
	102 - 1K ohms
	202 - 2K ohms
	502 - 5K ohms
	103 - 10K ohms
	203 - 20K ohms
	503 - 50K ohms
	104 - 100K ohms

For more information about this product, visit our website at: [www.potentiometers.com](http://www.potentiometers.com)



© State Electronics  
 36 State Route 10, STE 6 • East Hanover, NJ 07936-0436  
 973-887-2550 • Toll Free 1-800-631-8083 • Fax 973-887-1940  
<http://www.potentiometers.com>