

**SERIES 2640**  
**7/8" Diameter**  
**Analog Turns Counting Dial**



For more information about this product, visit our website at: [www.potentiometers.com](http://www.potentiometers.com)



Model	2646	2647	2641
Counting Capacity, Maximum Turns	20		15
For Shaft Diameter	1/4"		1/8"
For Bushing Diameter	3/8"		1/4"
Depth: Maximum, From Face of Panel	0.900"		0.82"
Shaft Extension: Maximum, From Face of Panel	0.781"		0.672"
Minimum, From Face of Panel	0.628"		0.469"
Bushing Extension: Maximum, From Face of Panel	0.300"		0.270"
Locking Mechanism	Positive Action with Detent		Positive Action
Weight, Nominal	0.60 oz.		
Number of Set Screws	1	2	1
Numeral Height	0.050"		
Knob Material	Black Plastic		
Dial Finish	White Numerals on Black Matte		
Housing Finish	Satin Chrome		
Operating Temperature Range	-55°C to +71°C		
	2646S	2647S	
Counting Capacity, Maximum Turns	15		
For Shaft Diameter	1/4"		
For Bushing Diameter	3/8"		
Depth: Maximum, From Face of Panel	0.94"		
Shaft Extension: Maximum, From Face of Panel	0.781"		
Minimum, From Face of Panel	0.578"		
Bushing Extension: Maximum, From Face of Panel	0.300"		
Locking Mechanism	Positive Action		
Weight, Nominal	0.60 oz.		
Number of Set Screws	1	2	
Numeral Height	0.050"		
Knob Material	Black Plastic		
Dial Finish	White Numerals on Black Matte		
Housing Finish	Satin Chrome		
Operating Temperature Range	-55°C to +71°C		

# SERIES 2640

## Outline Dimensions (Inch/mm)

Nominal Panel Hole Dimensions

Model	Dim.A	Dim.B
2601	$\frac{.281}{7.14}$	$\frac{.281}{7.14}$
2606,2607, 2606S&2607S	$\frac{.406}{10.3}$	$\frac{.375}{9.53}$

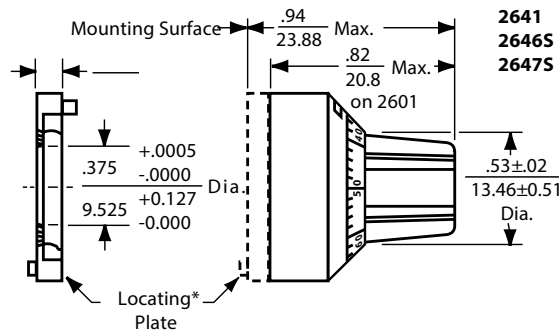
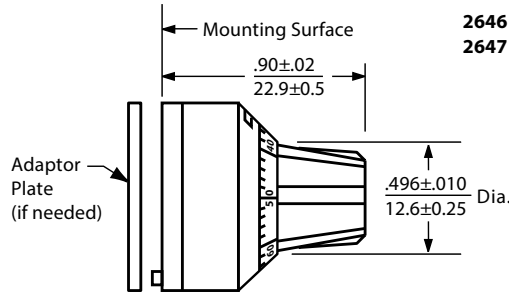
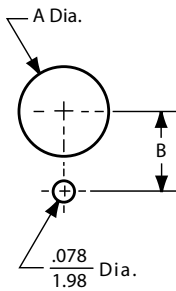

\*Model 2641 supplied with locating washer instead of locating plate.

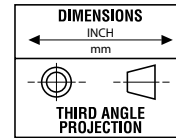
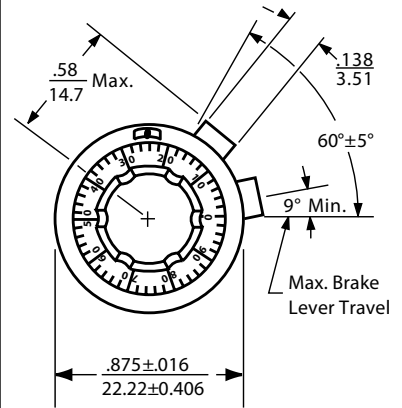

Specifications subject to change without notice.

For more information about this product, visit our website at: [www.potentiometers.com](http://www.potentiometers.com)

